

1. IR helicopter instruction

Thanks for purchasing our product. To help you operate the product more easily, we kindly recommend you to read the INSTRUCTION carefully before operating. Please keep this INSTRUCTION for future reference.

1. This product has high-stability.
2. Helicopter: 3.7V 120mAh Li-poly; Transmitter: 6 x 1.5V AA battery Helicopter could fly 6-7 minutes if fully-charged.

2. Safety Precaution

1. Read the instruction carefully before operating. Strictly follow the INSTRUCTION when operating.
2. Keep the small elements of the product away from the kids, in case of CHOKING accident.
3. Do not put the batteries in heat (fire, electronic heating device, etc.)
4. Human being should be 3 meters away from the helicopter when it is flying.
Make sure the helicopter doesn't hurt people's face, head or body.
5. Do not modify the product without reference, or else it will probably be out of order.
6. Keep your helicopter in your sight for easier control.
7. Parental guidance is highly recommended for the children's safety.

3. Component elements

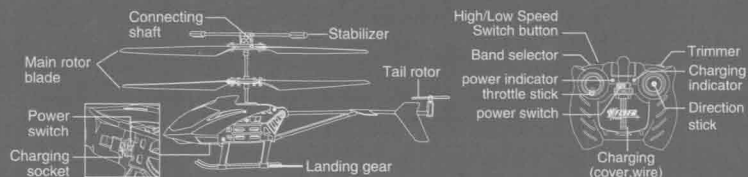

4. Install the remote batteries

- 1) Use a screw driver to open the cover of the batteries. (Pic 1)
- 2) Place 6 "AA" size batteries into the battery compartment. (Pic 2)
- 3) Tighten the screw. (Pic 3)

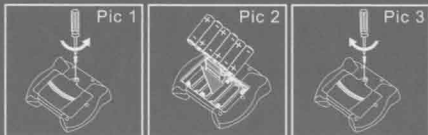

5. Attention

1. If the battery power of the transmitter goes low, the control distance would be much shorter.
2. If the battery power of the helicopter goes low, the helicopter could not fly to a high position or even fly.
3. The remote-control-range is about 10 meters, if the helicopter fly. Out of this range, it may lost control.
4. Repair immediately when the helicopter is damaged or out of shape. (eg. If the rotor is seriously broken, stop flying, or else it may cause some accident.)

6. Flying control

Up		Slowly pushing the gear lever up to raise the helicopter up.	
Down		Slowly pushing the gear lever down to fly it to a lower place.	
Left		Slowly turn the direction stick to the levorotation.	
Right		Slowly turn the direction stick to the dextrorotation.	

7. Extra tips for controlling

If the direction stick was not touched but the helicopter keep spinning, try to adjust as the picture shows:

1) If the helicopter keep spinning clockwise or keep turning towards the right, series press the "Trimmer" towards the left, till it could fly straight forward.			
2) If the helicopter keep spinning anticlockwise or keep turning towards the left, series press the "Trimmer" towards the right, till it could fly straight forward.			