

RADIO CONTROL VEHICLE AMPHIBIOUS STUNT CAR

ITEM NO.:989-393
INSTRUCTION MANUAL

XIONGQI TOYS FACTORY
CHENGHAI District, Shantou City, Guangdong Province, China
R/C SERIES NO.989-393

auxiliary equipment: Spectrometer, network analyzer.
PCB: 989-393R-2.4G
Product software version: TXA6-FD1428:RXA6-55394F
Product frequency band: 2405MHZ-2474MHZ
Maximum output power: -1.190BM

THANK YOU VERY MUCH FOR YOUR PURCHASE OF THE COMPANY'S PRODUCTS - AMPHIBIOUS CRAFT BEFORE USING THIS PRODUCT, PLEASE READ THE INSTRUCTION MANUAL CAREFULLY SO THAT IT CAN BE USED CORRECTLY AND SAFELY. PLEASE BE SURE TO KEEP THE INSTRUCTION MANUAL FOR REFERENCE.
AMPHIBIOUS CRAFT AMPHIBIOUS CRAFT

NOTE:

- (1)The new Ni-Cd battery pack included in this set needs to be charged before use.
- (2)Plug the charger to a wall outlet and join the battery's connector and the charger's connector.
- (3)Please charge for at least 8 hours for the first 2 times. Then, it's enough to charge for 5-6 hours during normal use. Do not overcharge as it will not fill the battery with more power.
- (4)Please check on a regular basis the wire, plug and other electric parts on the toy, batteries and charger. If any damage is found, please repair it before use.

1. SPECIFICATION AND PERFORMANCE

1. FULL FUNCTION: GO FORWARD, BACK OFF, TURN LEFT, RIGHT, STOP;
2. BATTERIES: USE 7.2V RECHARGEABLE BATTERIES, USE 2 X 1.5V "AA" BATTERIES FOR REMOTE CONTROL
3. R/C DISTANCE: 70M

2. COMPONENT CONTENT AND FEATURE

AMPHIBIOUS CRAFT

1. BATTERY BIN
2. BATTERY COVER
3. ON/OFF
4. DOUBLE STRENGTH SPIRAL

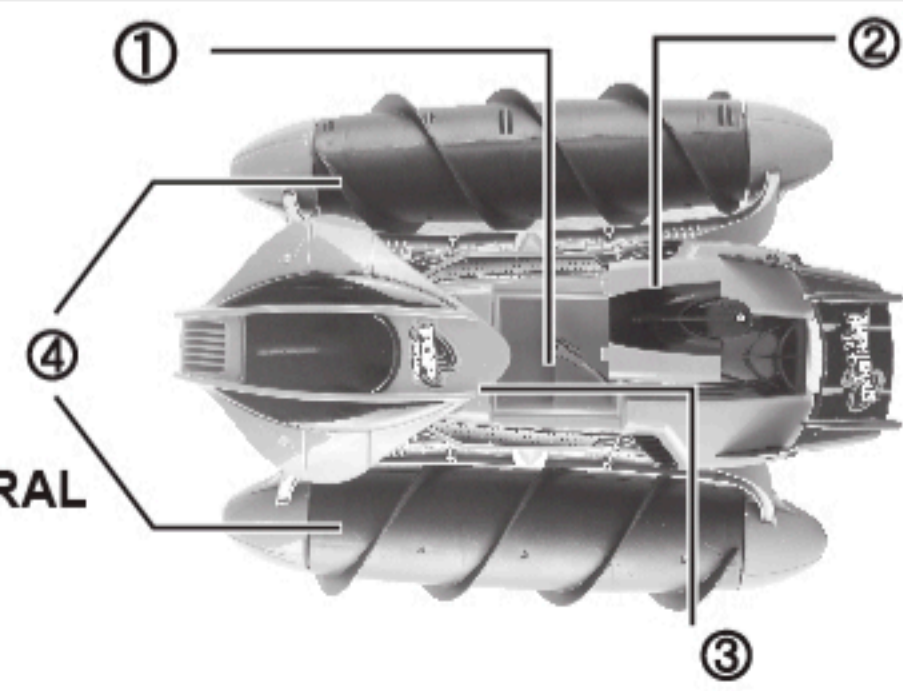

1

R/C FUNCTION

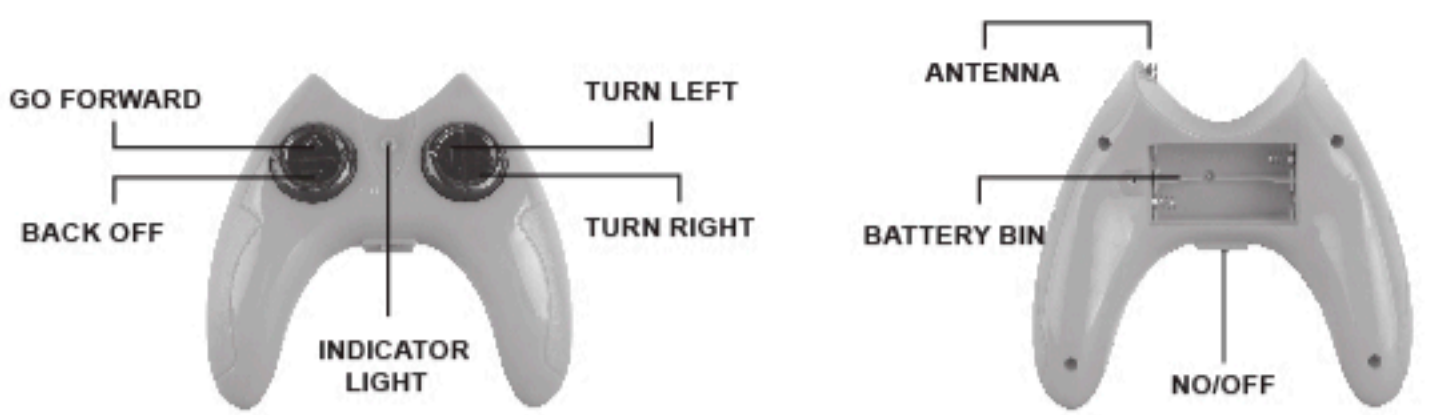

POWER SUPPLY SOCKET / BATTERY



3. OPERATION METHOD

PLEASE READ THE INSTRUCTION

- THE SURFACE OF DIFFERENT DIRECTION OF THE STEERING KEY CAN CONTROL AMPHIBIOUS CRAFT TO 8 DIFFERENT DIRECTIONS

BASIC DRIVING

A POWERFUL SPIRAL IS A PERFORMANCE THAT IS USED TO DRIVE STRAIGHT IN MORE AREAS. ASPHALT ROAD, CERAMIC TILE, HARD FLOOR AND OTHER SMOOTH SURFACE, CAN NOT PROVIDE ENOUGH FRICTION, AMPHIBIOUS CRAFT CAN NOT GO STRAIGHT, EVEN SO, HE CAN STILL WALK SIDE BY SIDE. THE FRONT AND REAR STEERING KEYS ARE ONLY AVAILABLE FOR THE CONTROL OF GRASSLANDS, SNOW, SAND AND WATER. TRAVEL BY SIDE. OPERATING SIDE KEY, AS SHOWN IN FIGURE.

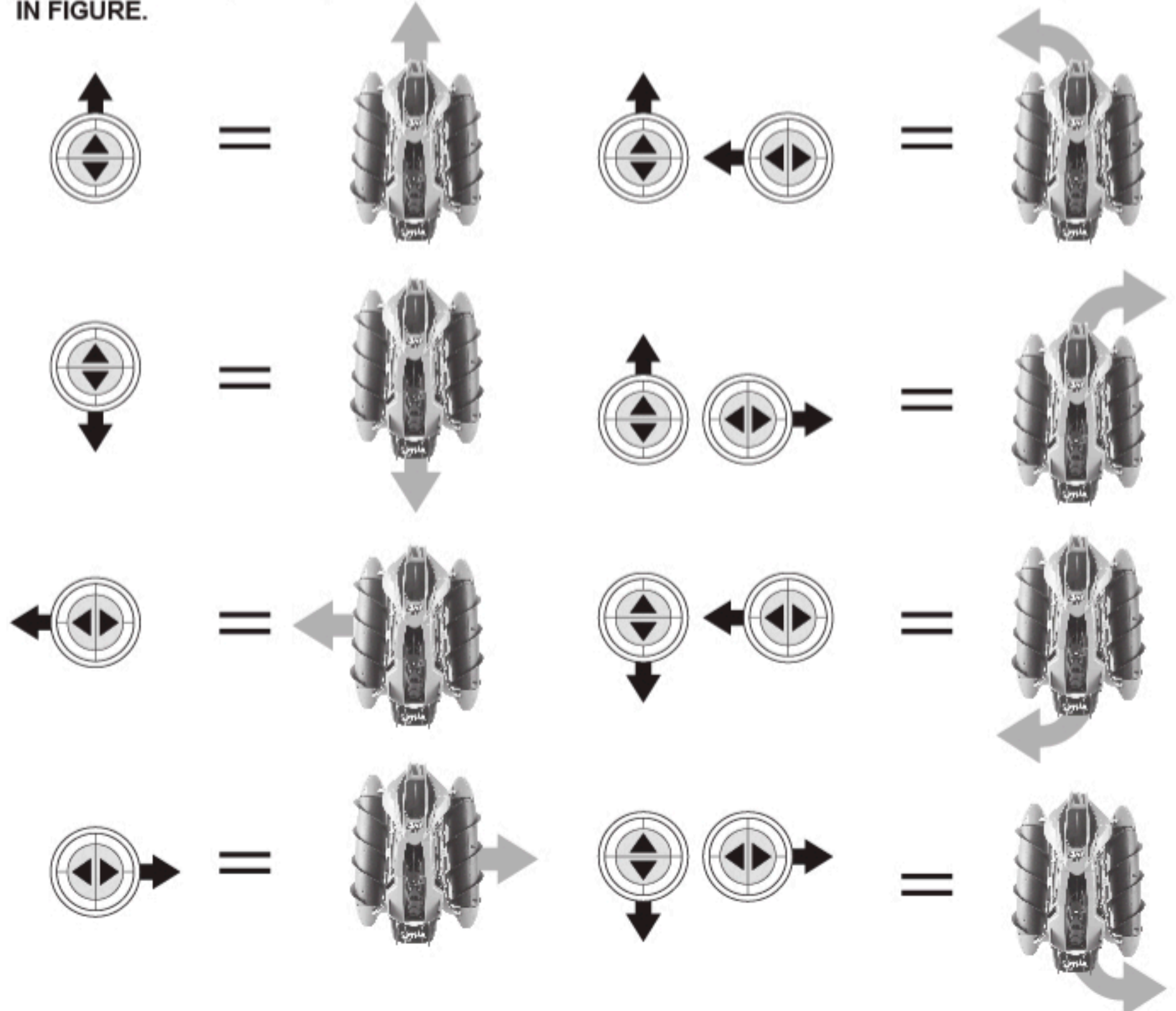

2

4. STUNT SPECIAL WATER

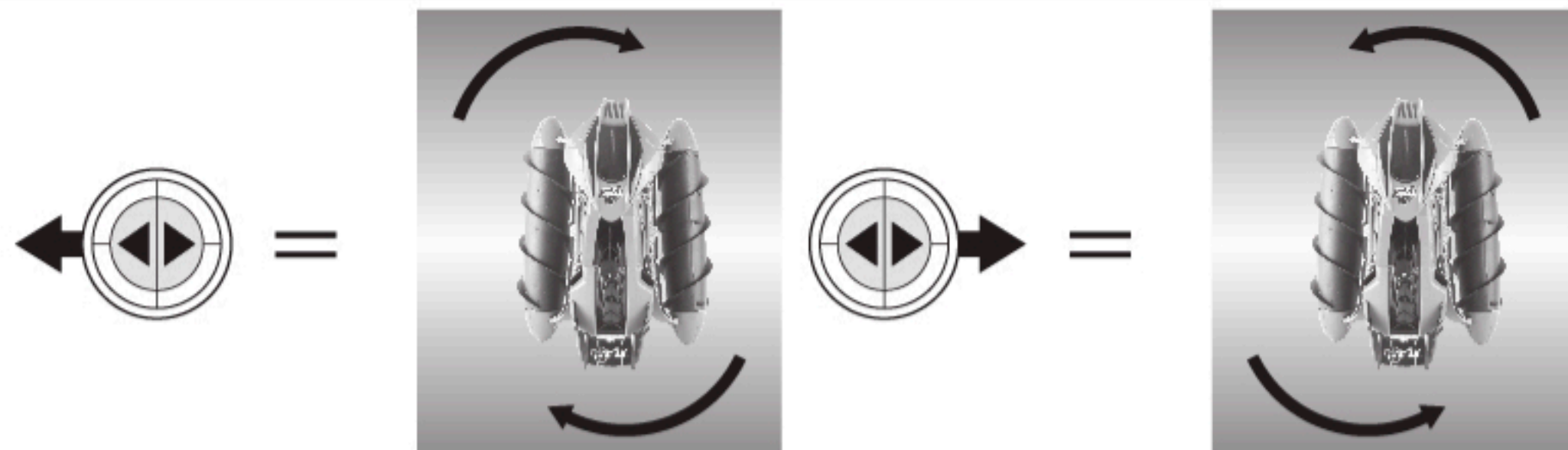

IT CAN ROTATE 360 DEGREES IN THE WATER. THIS IS SPECIAL SKILLS IN THE WATER, AND ON LAND, THIS OPERATION WILL STAGED COOL "SWIPE"

5. PROFESSIONAL DRIVING ADVICE

1. IN THE THIN CARPET, IT MAY SOMETIMES SLIP TO THE SIDE IN STRAIGHT AHEAD WHEN. THIS IS THE NORMAL PHENOMENON OF A POWERFUL SPIRAL FORWARD, IN ORDER TO REGAIN CONTROL, CAN ONLY SIMPLY DRIVE THE LEFT OR RIGHT, OR RELEASE A REMOTE CONTROL, IT WILL BE ABLE TO RE TRAVEL.
2. WHEN DRIVING IN THE SNOW, THE REMOTE CONTROL PERFORMANCE DEPENDS ON THE DEPTH OF THE SNOW AND HUMIDITY. THE BEST RESULT IS: YOU CAN BUCKLE THE DIRECTION KEY.
3. IT CAN TRAVEL FROM ONE TERRAIN TO ANOTHER. OF COURSE, IT CAN'T CROSS A VERY STEEP OR DIFFICULT TERRAIN. IN THAT CASE, IT'S VERY EASY TO SCRATCH.

6. BATTERY INSTALLATION AND CHARGING

AMPHIBIOUS CRAFT

1. ROTATE THE COVER OF THE BATTERY SCREW, OPEN THE BATTERY COVER
2. PLUG THE PLUG INTO THE 110V/220V SOCKET AND CONNECT THE OTHER END TO THE RECHARGEABLE BATTERY.
3. AFTER THE CHARGING IS COMPLETED, PLEASE DISCONNECT THE POWER SUPPLY AND THE BATTERY, THE BATTERY IS LOADED, COVER THE BATTERY COVER, MAY BE READY TO PLAY.
(IN ORDER TO CHARGE THE PRODUCT SAFELY, PLEASE PUT ON THE SCREW AND USE YOUR BATTERY AND CHARGER CORRECTLY.)

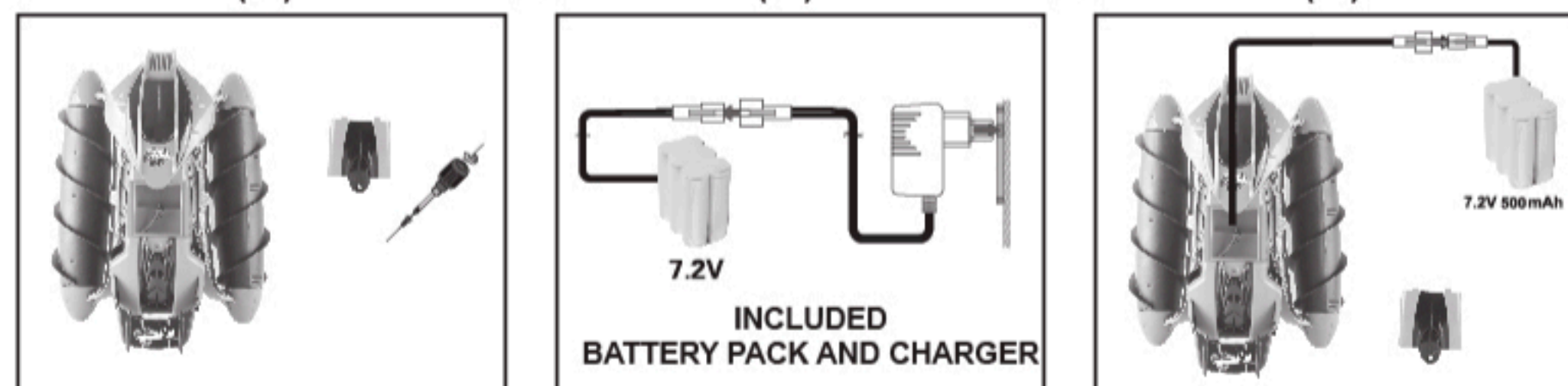

TIP: THE FIRST TIME TO PLAY, TO PUT ALL THE BATTERY RUN OUT, AND THEN CHARGE THE BATTERY, AND THEN EXHAUSTED BATTERY. AFTER THE BATTERY IS FULL AGAIN. DOING SO CAN EXTEND THE LIFE AND IMPROVE THE BATTERY PERFORMANCE. BE SURE NOT TO CHARGE THE BATTERY BEFORE YOU RUN OUT OF BATTERY. CHARGE FIRST TO DETERMINE THE BODY OF THE POWER SWITCH HAS BEEN CLOSED.

CHANGES OR MODIFICATIONS NOT EXPRESSLY APPROVED BY THE PARTY RESPONSIBLE FOR COMPLIANCE COULD VOID THE USER'S AUTHORITY TO OPERATE THE EQUIPMENT. THIS EQUIPMENT HAS BEEN TESTED AND FOUND TO COMPLY WITH THE LIMITS FOR A CLASS B DIGITAL DEVICE, PURSUANT TO PART 15 OF THE FCC RULES. THESE LIMITS ARE DESIGNED TO PROVIDE REASONABLE PROTECTION AGAINST HARMFUL INTERFERENCE IN A RESIDENTIAL INSTALLATION. THIS EQUIPMENT GENERATES, USES AND CAN RADIATE RADIO FREQUENCY ENERGY AND, IF NOT INSTALLED AND USED IN ACCORDANCE WITH THE INSTRUCTIONS, MAY CAUSE HARMFUL INTERFERENCE TO RADIO COMMUNICATIONS. HOWEVER, THERE IS NO GUARANTEE THAT INTERFERENCE WILL NOT OCCUR IN A PARTICULAR INSTALLATION. IF THIS EQUIPMENT DOES CAUSE HARMFUL INTERFERENCE TO RADIO OR TELEVISION RECEPTION, WHICH CAN BE DETERMINED BY TURNING THE EQUIPMENT OFF AND ON, THE USER IS ENCOURAGED TO TRY TO CORRECT THE INTERFERENCE BY ONE OR MORE OF THE FOLLOWING MEASURES:
-- REORIENT OR RELOCATE THE RECEIVING ANTENNA.
-- INCREASE THE SEPARATION BETWEEN THE EQUIPMENT AND RECEIVER.
-- CONNECT THE EQUIPMENT INTO AN OUTLET ON A CIRCUIT DIFFERENT FROM THAT TO WHICH THE RECEIVER IS CONNECTED.
-- CONSULT THE DEALER OR AN EXPERIENCED RADIO/TV TECHNICIAN FOR HELP.

3

R/C

1. USING CROSS SCREWDRIVER COUNTERCLOCKWISE UNSCREW THE BATTERY COVER SCREWS ON THE OPEN, OPEN THE BATTERY COVER (FIGURE 1);
2. 2X 1.5V "AA" BATTERY ACCORDING TO THE INSTALLED POWER IS NEGATIVE (FIGURE 2).
3. COVER THE BATTERY COVER AND SCREW ON THE SCREW WITH A CROSS SCREWDRIVER (FIGURE 3);

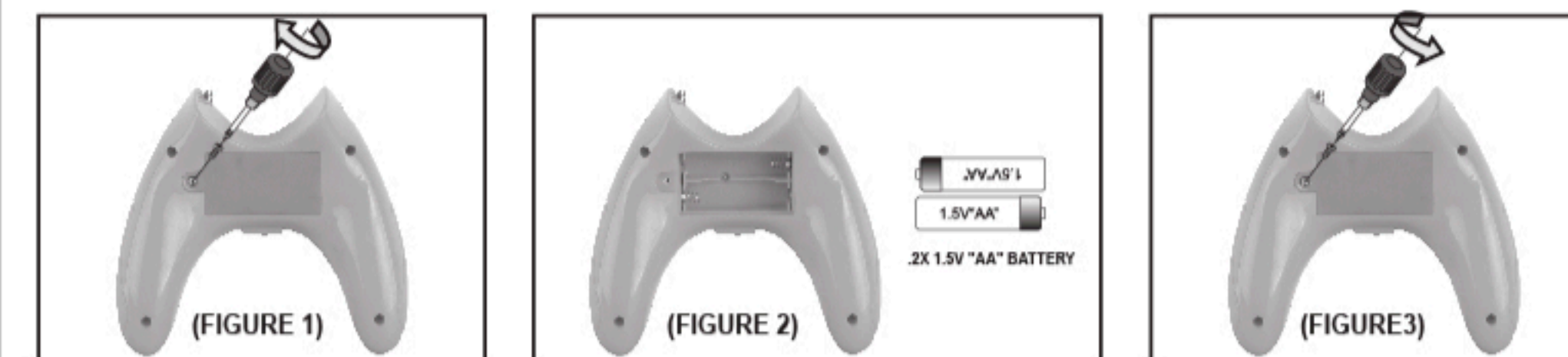

7. TIP

1. WHEN THE AMOUNT OF THE POOL IS INSUFFICIENT, IT WILL LOSE SOME FEATURES OR PERFORMANCE, PLEASE RE - CHARGE.
2. TRAVEL TIME DEPENDS ON THE TYPE OF TRAVEL AND DRIVING ENVIRONMENT.
3. RADIO INTERFERENCE WILL REDUCE THE PERFORMANCE OF THE PRODUCT. PLEASE STAY AWAY FROM OTHER LARGE RADIO TOOL EQUIPMENT.
4. DO NOT BEND AND BREAK THE ANTENNA, THIS WILL AFFECT THE REMOTE CONTROL DISTANCE, MAY GUIDE OUT OF CONTROL.
5. DO NOT PUT IN THE PLACE WHERE THE TEMPERATURE IS TOO HIGH OR DIRECT SUNLIGHT. MAKE SURE THAT THE SWITCH IS CLOSED AND THE BATTERY IS PULLED OUT OF THE BODY AND STORED IN A COOL PLACE.
6. AFTER USE, PLEASE CLEAR WATER, DUST OR DIRT PLACE, TO FIGHT THE BOAT COVERED WITH A CLEAN DRY CLOTH. TO ENSURE THE SAFETY OF THE SHIP IS SAFE AND DRY WITHOUT WATER IN THE AIR.
7. CONTROL YOUR BOAT IN THE CLEAR CALM WATER. THE BEST CHOICE OF A PUDDLE OR A SHALLOW POND. DON'T OPERATE IN SALT WATER
8. AFTER A WHILE IN THE WATER, YOU NEED TO PAY ATTENTION TO THE POSITION OF THE SHIP, TO DETERMINE IT NEAR THE EDGE OF THE WATER. SO THAT YOU CAN RECOVER BEFORE THE POWER CONSUMPTION OF THE WATER AND LAND WARFARE.
9. DO NOT PLACE THE REMOTE CONTROL IN THE WATER, IF NOT CAREFULLY PLACED IN THE WATER, IMMEDIATELY PUT THE BATTERY AND PUT THE REMOTE CONTROL DEVICE IN A COMPLETELY DRY AIR. INSTALL A NEW BATTERY AND THEN RE OPERATION.

ABOUT FREQUENCY AND FIELD

1. IF THE SAME FREQUENCY OF THE CAR IN THE VICINITY OF THE SAME OPERATION, THE CONTROL OF THE REMOTE CONTROL MAY FAIL.
2. IF THE INTERFERENCE OF OTHER BATTERIES, CONTROL WILL FAIL. PLEASE TRY TO CHANGE THE PLACE OF PLAY OR OTHER TIMES.
3. THIS PRODUCT IS SUITABLE FOR DRIVING IN A CLEAR CALM WATER, THE BEST CHOICE OF A PUDDLE OR A SHALLOW POND.



WARNING: CHOKING HAZARD - Small parts.
Not for children under 72 months

6+



4